

146-S-62 - SPEEDLINE System Data Sheet - Version V1 (24-10-23)

SPEEDLINE 146mm 'C' Stud Partition @600mm
Ctrs, with 2x Siniat GTEC 15mm Fire Board each
side

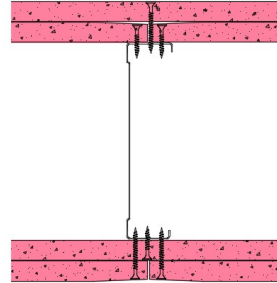

System Performance Breakdown

Fire Resistance:

BS476 Part 22:1987:

Test Ref & Date or Applied Ref & Report:

Max Height:

Thickness:

Duty Grade: BS 5234: Part 2:1992:

Sound Insulation:

120/120 Minutes (Integrity/Insulation).

BTC 17593FA - BRE Report P102396-1011C

Refer to Speedline Specification Clause

208 mm. (At Base Track, Excluding Finishes)

Severe - Annexes A-F

54 R_w dB, Date Tested or Assessed Against - 08/07/2016

Test Code:
H19649AA
Test Date:
08/07/2016

Freq. Hz	R dB
50	21.4
63	23.7
80	22.5
100	31.6
125	35.7
160	40.1
200	46.9
250	49.0
315	49.8
400	55.5
500	58.1
630	58.1
800	59.9
1 000	60.9
1 250	62.5
1 600	61.0
2 000	50.5
2 500	47.8
3 150	53.1
4 000	56.6
5 000	60.2

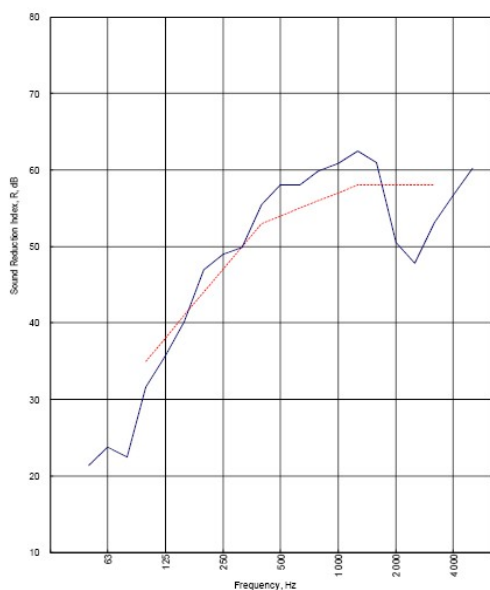



Rating according to BS EN ISO 717-1:2013
Evaluation based on laboratory measurement results obtained by an engineering method:

R_w (C;Ctr) = 54 (-2;-6) dB
Max dev. 10.2 dB at 2 500 Hz

$C_{50-3150}$ = -5 dB $C_{50-5000}$ = -4 dB $C_{100-5000}$ = -2 dB
 $C_{tr,50-3150}$ = -14 dB $C_{tr,50-5000}$ = -14 dB $C_{tr,100-5000}$ = -6 dB

TESTED AT ONE OF THE UKAS ACCREDITED LABORATORIES BELOW

B.T.C (H-Ref on Graph) 

B.R.E 

AIRO 

S.R.L 

Customer: Voestalpine Metsec Plc Dry Lining

BTC 19649A: Page 9 of 12



SPEEDLINE Drywall Systems, Adsetts House, 16 Europa View, Sheffield Business Park, Sheffield, S9 1XH.

Tel: 0114 231 8030.

Email: enquiries@speedlinedrywall.co.uk

(As per the requirements set out in ISO/IEC 17025:2017 regarding test data the results stated have been carried out by voestalpine Metsec plc as part of the contract to supply Speedline Metal Sections to SIG Plc)